

Thank you for purchasing our
**Cresco 15SW Assembled
Fertilizer Spreader**



**We're delighted to have you as a customer
and are here to help! First off, let's get your
product assembled!**

Table of Contents:

- 1: Spare Parts**
- 2: Assembly**
- 3: Warranty**

Scan for video assembly



Spare Parts

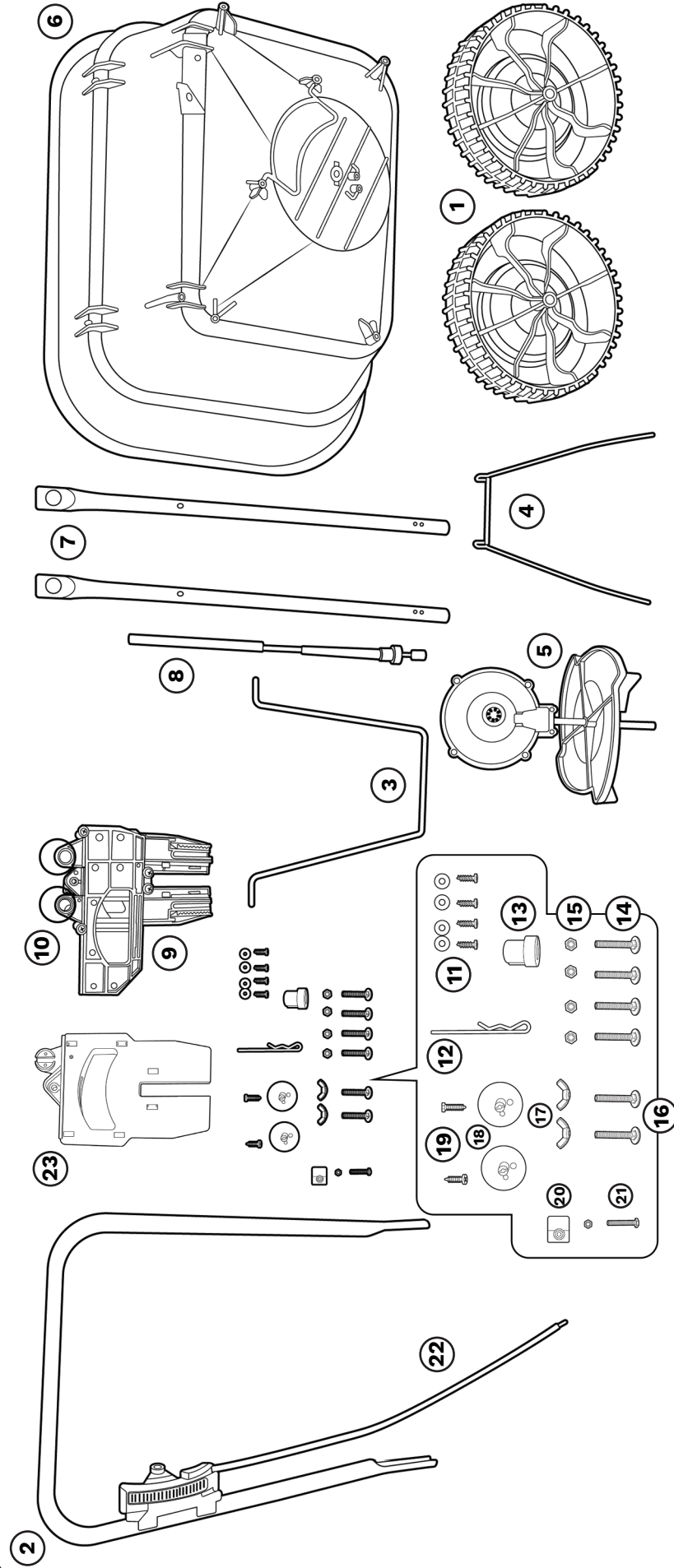

Empty all contents of the box onto a flat surface and count parts to make sure all are there.

CRESCO 15SW PARTS LIST:

- | | | | | |
|------------------------------|--------------------------|------------------------------|---------------------------------|-------------------------------|
| 1. Wheels (X2) | 6. Hopper | 11. Screws and Washer | 16. M6 x 40 screws | 20. Cable Fixing Clamp |
| 2. Handle Bar | 7. Lower Frames | 12. Agitator | 17. M6 wing nuts | 21. Cable fixing screw |
| 3. Backstand | 8. Axle & Bushing | 13. Bushing | 18. Wheel Stoppers | 22. Cable Linkage |
| 4. Cable Back Stand | 9. Summer Slider | 14. M6 x 35 bolts | 19. Wheel stopper screws | 23. Winter Slider |
| 5. Gearbox & Impellor | 10. Adjustor | 15. M6 lock nuts | | |

Scan to view and purchase spare parts:



Slide System **Explanation**

***** VERY IMPORTANT *****

Your Cresco spreader comes with two different application sliders. One is for winter and the other is for summer!



DO NOT SPREAD FERTILIZER WITH THE WINTER SLIDER

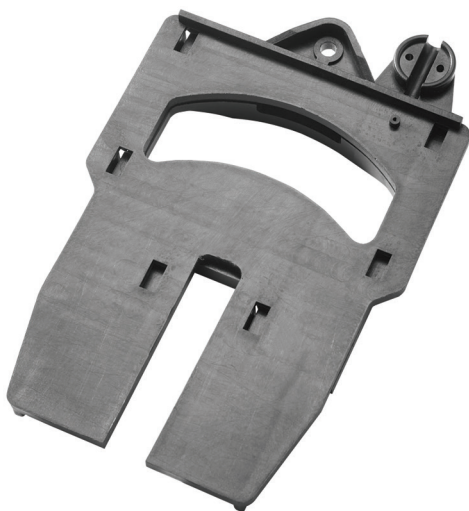

Winter Slider

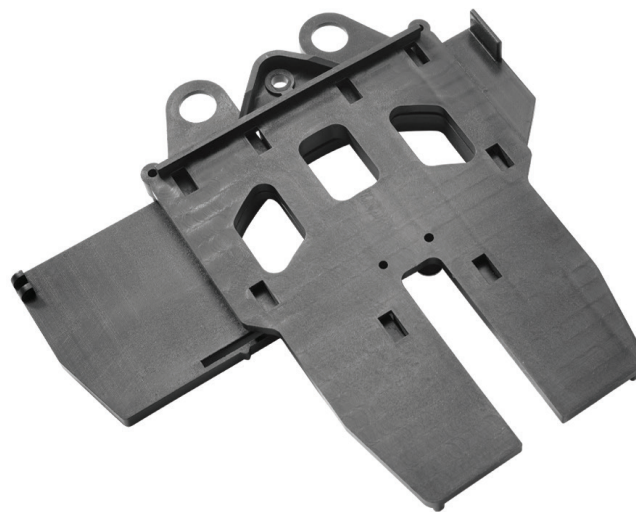

Summer Slider

Please locate and choose your slider.

Cresco 15SW Set Up

The Cresco 15SW spreader is a ready to use spreader. No tools are needed for assembly.

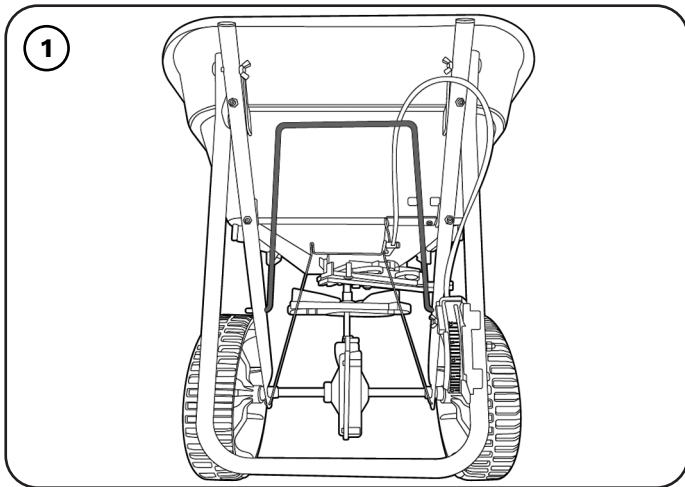

Carefully remove the spreader and its instruction manual from the box.

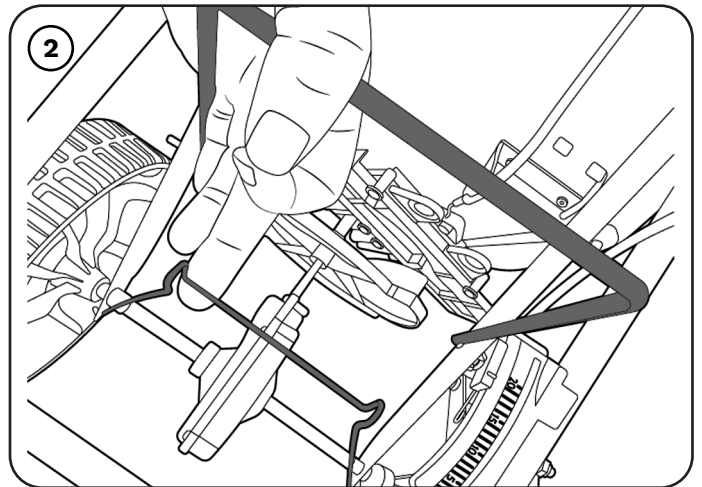

Clip the back stand (3) into the cable back stand (4).

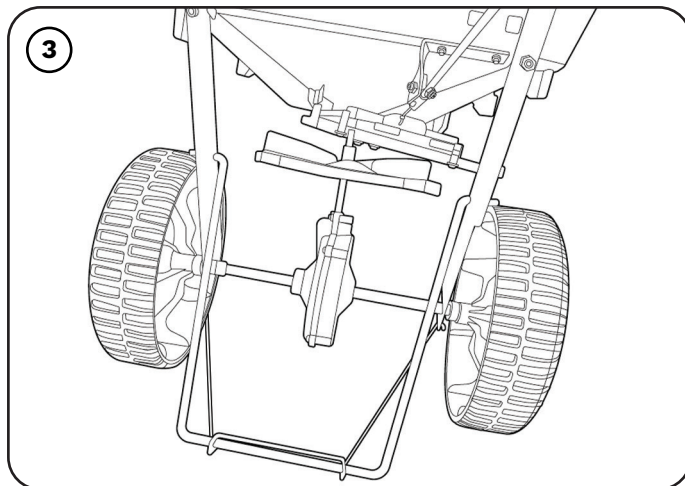

Your back stand should now look like this.

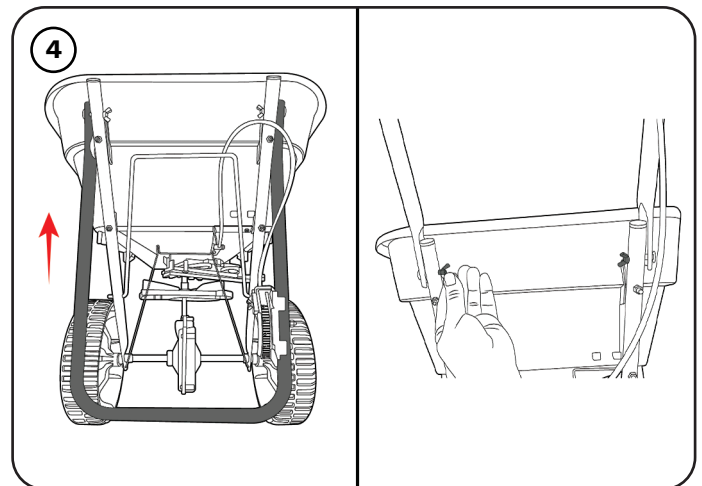

Take the handlebar (2) and pull it into position as shown. Tighten the M6 wingnuts (18) to fix in position.

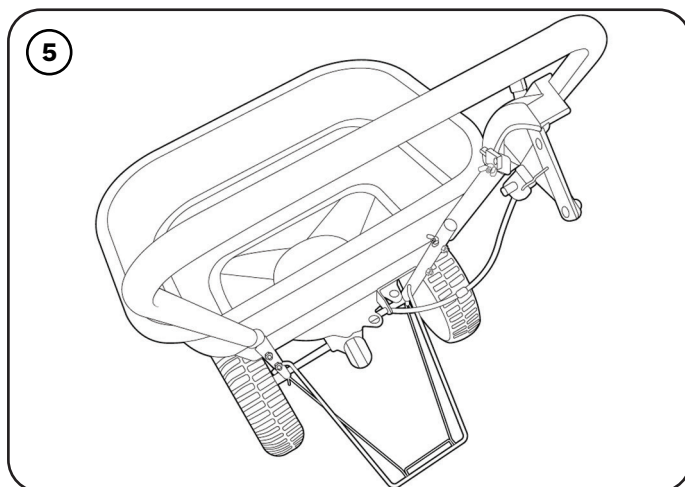

Your Cresco 15SW spreader is now ready for use, please refer to the manual for further information and guidance on how to achieve best results from the spreader. Alternatively, visit the Cresco website, at www.crescospreaders.com

Slide System **Explanation**

Winter

For spread width 6 meters.



Pavement setting (2 meters).



Ice Melts



Summer

The summer slide system comes with 20 different settings and a border control. This slider provides control over the accuracy of your spreading.

Large/Heavy Materials

Small/Light Materials

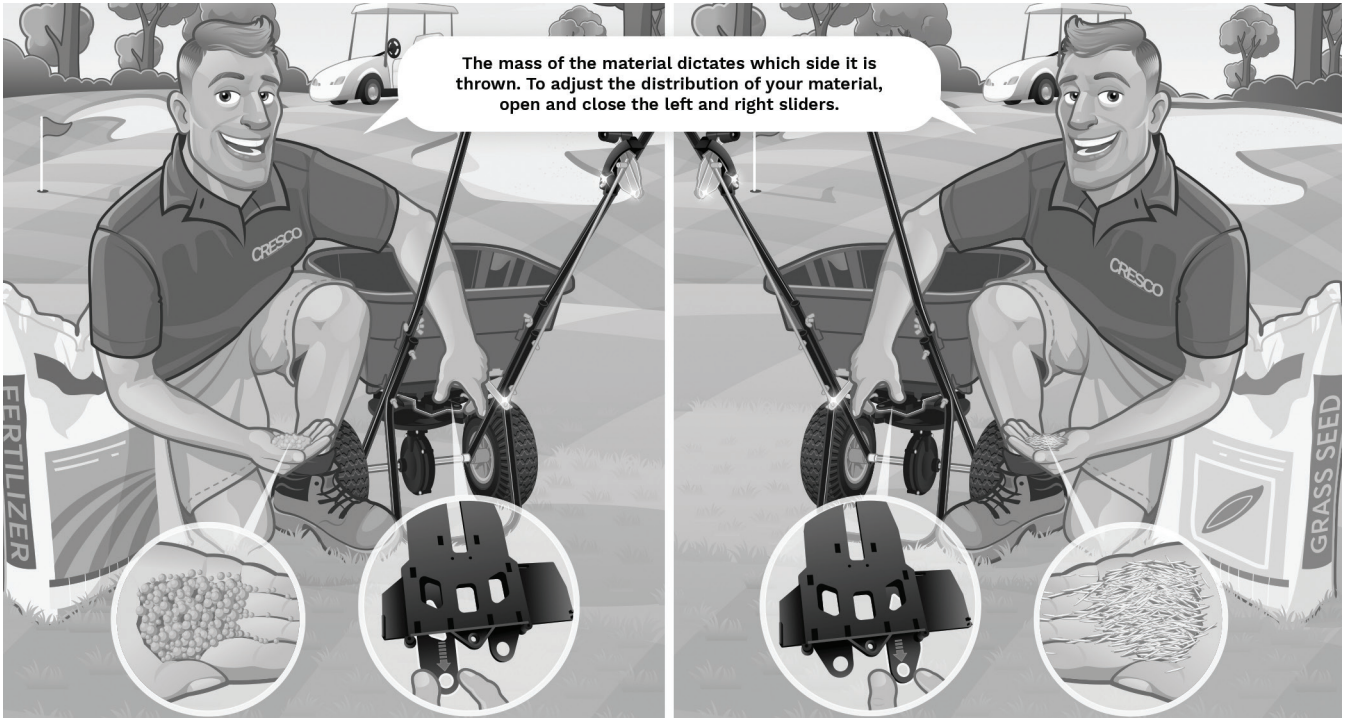

Border Control



To protect your borders simply slide the border control into position to cut off the left hand side of the spread pattern.

Slide System **Explanation**

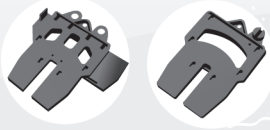

**SLIDE-SYSTEM
TECHNOLOGY
SETTINGS**

**TWO SEASONS.
ONE SPREADER.**



PRODUCT		SUMMER SLIDER	SLIDER ADJUSTER SETTINGS	
	POWDERED OR MICRO GRANULAR FERTILIZER		NO ADJUSTMENT OF EITHER SLIDER RECOMENDED	
	MEDIUM GRANULAR FERTILIZER		NO ADJUSTMENT OF EITHER SLIDER RECOMENDED	
	LARGE GRANULAR FERTILIZER		ADJUSTMENT OF THE LEFT SLIDER RECOMENDED 6-7 CLICKS	
	GRASS SEED OR VERY LIGHT MATERIALS		ADJUSTMENT OF THE RIGHT SLIDER RECOMENDED 3-4 CLICKS	
	PELLETED MATERIALS		ADJUSTMENT OF THE LEFT SLIDER RECOMENDED (SELECT CLOSED)	
	LARGE GRANULAR ICE MELTS		ADJUSTMENT OF THE LEFT SLIDER RECOMENDED (SELECT CLOSED)	
WINTER SLIDER				
** Please note this chart is a guide only. Due to variations in the spreading characteristics of materials, accurate calibration should be carried out by the operator for each different materal being applied.**				
	SHARP SAND		FULL OR REDUCED WIDTH SLIDER OPTION RECOMENDED	
	FLOWABLE SAND / SOIL MIX		FULL SLIDER WIDTH USE RECOMENDED	
	COARSE MARINE SALT		FULL OR REDUCED WIDTH SLIDER OPTION RECOMENDED	
	ROCK SALT		FULL SLIDER WIDTH USE RECOMENDED	
	GRIT MATERIALS		FULL SLIDER WIDTH USE RECOMENDED	

WWW.CRESCOSPREADERS.COM

DMMP Limited is not responsible for misaplication due to incorrect use or incorrect calibration of Cresco spreaders, and any other DMMP Limited spreader brands.

For calibration information please refer to "how to calibrate" section on the Cresco website.



How to use the **Cresco 15SW**

How to Apply Fertilizer to your lawn like a pro in four steps!

Step 1: Understanding the application rate and settings

Step 2: Preparing the Spreader

Step 3: Walking Patterns for the optimum application

Step 4: Cleaning & Maintenance

Step 1: Understand the application rate and settings

Application Rate Settings

Check the back of the fertilizer bag to find out the recommended G/m² and spreader application setting.



If the spreader setting is not on the back of the bag, please get in touch with your fertilizer bag provider.



Set the handle to the correct setting.

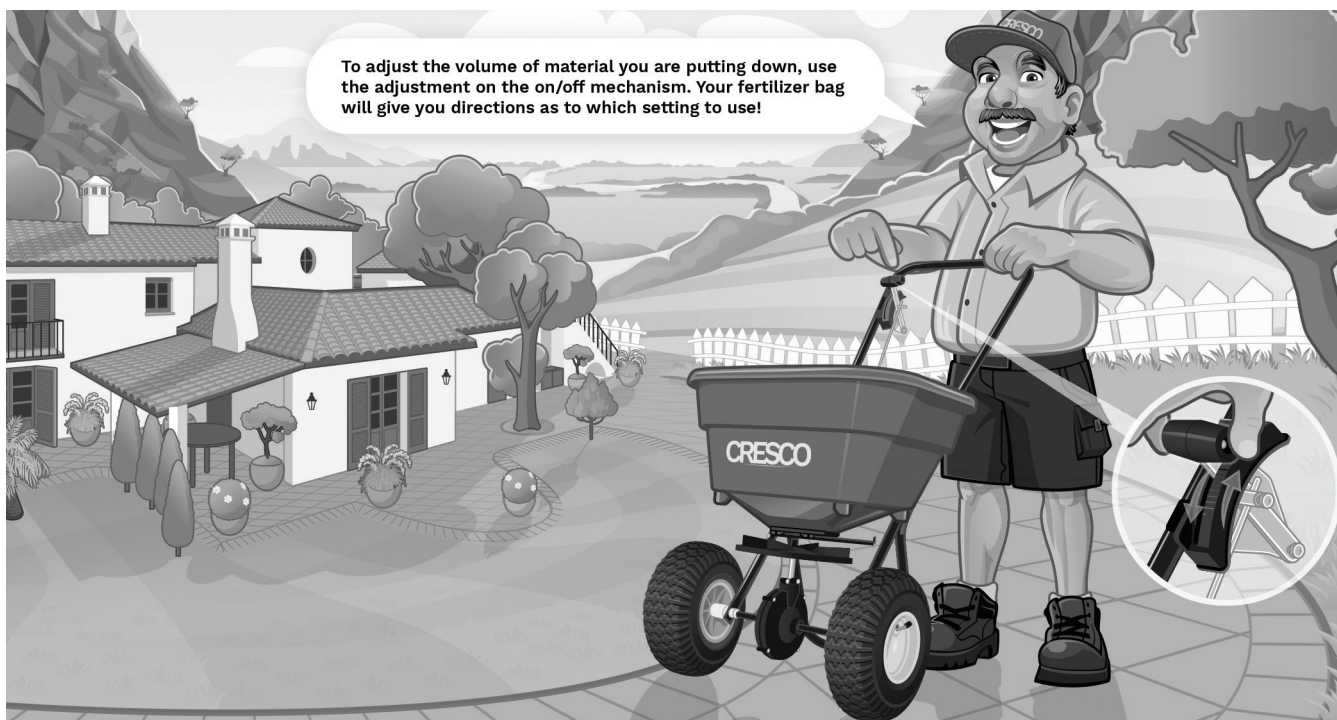

If you are unable to find the required Cresco volume setting, please visit, www.crescospreaders.com

How to use the **Cresco 15SW**

Spread Pattern Settings

Once you have the correct application rate, you will need to check that the spread of material is even on both sides of the spread pattern.

To balance the spread pattern for your material, check online or with your fertilizer or seed provider.

For a quick reference, please refer to our guide on the previous page.

CRESCO SLIDE-SYSTEM TECHNOLOGY SETTINGS		TWO SEASONS. ONE SPREADER.	
PRODUCT	SUMMER SLIDER	SLIDER ADJUSTER SETTINGS	
 POWDERED OR MICRO GRANULAR FERTILIZER		NO ADJUSTMENT OF EITHER SLIDER RECOMENDED	
 MEDIUM GRANULAR FERTILIZER		NO ADJUSTMENT OF EITHER SLIDER RECOMENDED	

Step 2: Preparing the Spreader

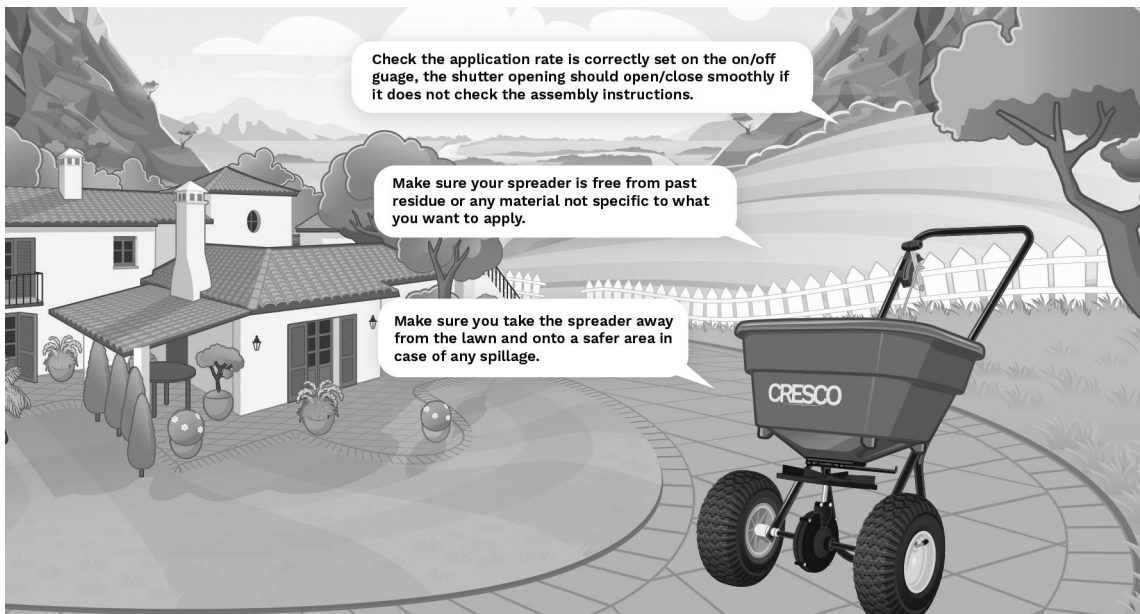

Check the material to be applied is dry and free flowing to ensure it will flow freely through the hopper. Make sure your application rate and spread pattern settings are correct, **close the application hole fully** and then pour in your material.

How to use the **Cresco 15SW**

Your outlet hole should look like this before you pour in any material.



It is preferable to spread when the weather is dry, however a rain cover can be added to your spreader to ensure the material in your hopper is not exposed to moisture.



WARNING **Do not pour material in the hopper when the application holes are open as it can lead to spillages or leaks that can damage the area. Do not open the gauge until you are over the area you want to spread and are moving at a brisk walk***

Step 3: Walking Patterns for the optimum application (For Fertilizer Only)

There are two methods of effective spreading, longitudinal fertilizer spreading and cross sectional fertilizer spreading.

When applying fertilizer please make sure you walk at 3mph and keep the hopper in a stable, upright position.

How to use the **Cresco 15SW**

Single Pass Fertilizer Spreading

Use ½ the application rate suggested on the back of your fertilizer bag.

Cover the area as shown by passing over it in an up and down track as shown, taking into account the spread width of the material being applied.

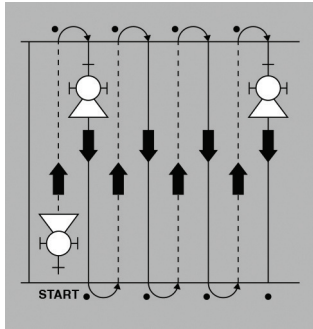

Cross Sectional Fertilizer Spreading

Use ½ the application rate suggested on the back of your fertilizer bag.

Cover the area as shown. Repeating by a second pass in the same manner going across the area as shown in the diagram.

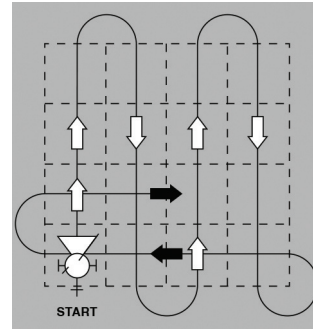

Step 4: Cleaning and Maintenance

CLEANING THE SPREADER THOROUGHLY WILL SIGNIFICANTLY ENHANCE THE LIFESPAN OF YOUR SPREADER AND IMPROVE IT'S ABILITY TO SPREAD EVENLY NEXT TIME YOU USE IT.



Calibration Setting Guide

Speed		Product											
Mph	3	05mm - 1mm				1mm - 2mm				3mm - 5mm			
Kph	4.828	3.5	3.5	3.5	3.5	4.0	4.0	4.0	4.0	4.5	4.5	4.5	4.5
Metres p/Sec	1.34	20	35	50	50	20	35	50	50	20	35	50	50
Width	Metres	10	10	10	10	10	10	10	10	10	10	10	10
Application Rate	Grams /Sq M	13.4	13.4	13.4	13.4	13.4	13.4	13.4	13.4	13.4	13.4	13.4	13.4
Run Time	Secs	47	47	47	47	54	54	54	54	60	60	60	60
Distance	metres	938	1,876	3,015	3,015	938	1,876	3,015	3,015	938	1,876	1,876	3,015
Area	Sq Metres	8.5	11	14	14	11	13.5	19.5	13	18	18	18	16 (X2)
Target Weight	Grams	-	-	-	-	-	-	-	-	-	-	-	-
Setting													
Slider Position													

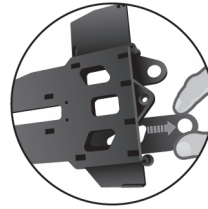

Left hand slider adjuster

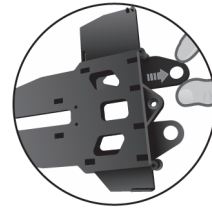

Right hand slider adjuster

LHS (Left hand slider adjuster) is recommended to be engaged when spreading large sized granular materials to provide a more uniform distribution on the left and right side of the spread pattern. Conversely with very light materials (e.g. grass seed) engaging the RHS (Right hand slider adjuster) will be similarly beneficial.

The manufacturer cannot be held responsible for any variations in sq. metre application volumes, or spread width differences, due to possible variations in materials, application conditions at the time and different operator application techniques.



Do not spread Fertiliser or seed materials with the winter slider

This chart should be used as a guide only.

3 Year **Limited Warranty**

DMMP Ltd. warrants this product free of defects in original workmanship and materials for a period of 3 year to the end user with the original dated purchase receipt.

If a manufacturing non-conformance is found, DMMP Ltd. will repair or replace the part(s) or product at it's discretion at no charge provided the failure is not the result of incorrect installation, mishandling, misuse, tampering, or normal wear and tear as determined by DMMP ltd.

DMMP Ltd. at its discretion may require that the part(s) or product be returned along with the original purchase receipt at owners' expense for examination and compliance with the terms of this warranty.

Do not return any product without first receiving authorization from DMMP Ltd. To seek remedy under this warranty, contact DMMP Ltd. at +44 (0)1455 825 400 or email us at info@dmmp.co.uk and describe the nature of the manufacturing defect.

SPECIFIC LIMITATIONS:

This warranty covers only the part(s) or product; any labour charges associated with repair or replacement of nonconformances are specifically excluded.

Due to the corrosive nature of most fertilizers and ice melt products, DMMP Ltd makes no warranty against and specifically excludes part(s) or product degradation or failure due to corrosion or its effects.

To negate the effects of corrosive materials on your product, clean and dry your spreader or seeder thoroughly after each use. As a further preventative measure, coat all metal parts with a light oil or silicon spray.

